



Operator's Manual

EW530 Weedbine

Model—Serial Range

EW530—AA01011 and Up

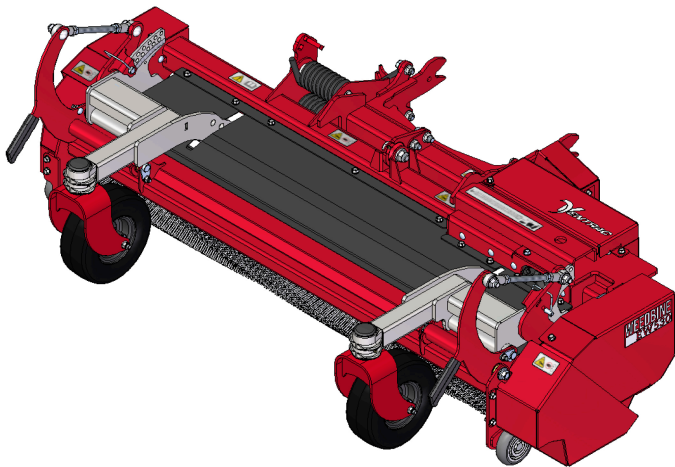

Reader Comments

Ventrac maintains a continuous effort to improve the quality and usefulness of its publications. To do this effectively, we encourage user feedback. Please comment on the completeness, accuracy, organization, usability, and readability of this manual by an email to techpubs@ventrac.com.

or Mail to:

**Technical Publications, Service
Ventrac by Venture Products Inc.®
500 Venture Drive Orrville, OH 44667**

Phone: 1-866-836-8722

Disclaimers and Regulatory Information

WARNING

CALIFORNIA Proposition 65

This product contains a chemical or chemicals known to the State of California to cause cancer, birth defects, or reproductive harm.



WARNING



Operating, servicing, and maintaining off-road equipment can expose you to chemicals including engine exhaust, carbon monoxide, phthalates, and lead, which are known to the State of California to cause cancer and birth defects or other reproductive harm. To minimize exposure, avoid breathing exhaust, do not idle the engine except as necessary, service equipment in a well-ventilated area and wear gloves or wash your hands frequently when servicing your equipment.

For more information go to www.P65Warnings.ca.gov

IMPORTANT

It is a violation of California Public Resource Code Section 4442 or 4443 to use or operate this engine on any forest-covered, brush-covered, or grass-covered land unless the exhaust system is equipped with a spark arrestor, as defined in Section 4442 maintained in effective working order or the engine is constructed, equipped, and maintained for the prevention of fire.

Table of Contents

Disclaimers and Regulatory Information	3
Chapter 1: Introduction	1-1
Intended Use	1-2
Product Description	1-2
Getting Help	1-2
Why do I Need an Operator's Manual?	1-3
Manual Conventions	1-4
Safety Alert Classifications	1-4
Chapter 2: Safety	2-1
General Safety	2-2
Training Required	2-2
Operation Safety	2-2
Weedbine Safety	2-5
Maintenance Safety	2-5
Fuel Safety	2-7
Safety and Instructional Decals	2-8
Chapter 3: Product Overview	3-1
Operational Controls	3-2
Height Adjustment Handles	3-2
PTO Drive Belt Tension Lever	3-2
Auger Drive Belt Tension Lever	3-3
Brush Drive Belt Tension Lever	3-3
Chapter 4: Operation	4-1
Before Operation	4-2
Daily Inspection	4-2
Attaching the Attachment	4-3
Setting the Operational Height	4-4
During Operation	4-5
Operating the Machine	4-5
After Operation	4-6
Detaching the Attachment	4-6
Hauling the Machine	4-6
Chapter 5: Maintenance	5-1
Recommended Maintenance Schedule	5-2
Lubrication Locations	5-3
Drive Belt Maintenance	5-4
Adjusting the PTO Drive Belt Tension	5-4
Adjusting the Auger Drive Belt Tension	5-5
Adjusting the Brush Drive Belt Tension	5-5
Replacing the Auger Drive Belt	5-6
Replacing the Brush Drive Belt	5-7
Replacing the PTO Drive Belt	5-7
Gearbox Maintenance	5-9
Checking the Gearbox Oil Level	5-9
Changing the Gearbox Oil	5-9
Auger Maintenance	5-10
Replacing the Auger	5-10
Brush Maintenance	5-12
Adjusting the Brush	5-12
Replacing the Brush	5-13
Storage	5-14

Preparing the Attachment for Storage	5-14
Removing the Attachment from Storage	5-14
Chapter 6: Troubleshooting	6-1
Chapter 7: Specifications	7-1
Dimensions.....	7-2
Chapter 8: Warranty	8-1
Limited Warranty — Ventrac Commercial Equipment.....	8-2



Table of Contents

Intended Use	1-2
Product Description	1-2
Getting Help	1-2
Why do I Need an Operator's Manual?	1-3
Manual Conventions	1-4
Safety Alert Classifications	1-4

Intended Use

The Ventrac EW530 Weedbine is intended to only be used with Ventrac traction units by professional operators in commercial applications. It is primarily designed to damage and kill weeds on well-maintained turf. Using this product for any purpose other than its intended use could prove dangerous to you and bystanders.

Read this information carefully to learn how to operate and maintain your product properly and to avoid injury and product damage. You are responsible for operating the product properly and safely.

Read and understand the traction unit *Operator's Manual* before operating the machine.

Product Description

The Ventrac EW530 Weedbine is designed to eliminate broad leaf weeds from grass without the use of chemicals or causing damage to the grass. Use the Weedbine dynamically (varying the pattern of use) on a weekly basis, before mowing, to effectively eliminate weeds from turf.

Getting Help

Visit www.Ventrac.com for product safety and operation training materials, accessory information, help finding a dealer, or to register your product.

Whenever you need service, genuine Ventrac parts, or additional information, contact an Authorized Service Dealer or Ventrac Customer Service and have the model and serial numbers of your product ready. These numbers are located on the serial plate on your product ①. Write the numbers in the space provided.

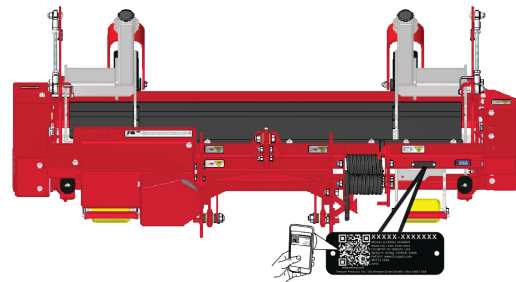

G539814

IMPORTANT

With your mobile device, you can scan the QR code on the serial number decal (if equipped) to access warranty, parts, and other product information.

Model Number:		Serial Number:	
----------------------	--	-----------------------	--

Why do I Need an Operator's Manual?

This manual has been created to help you gain the important knowledge of what is needed to safely operate and maintain your machine, and to avoid injury and product damage. It is divided into chapters for convenient reference of the appropriate information.

You must read and understand the *Operator's Manual* for each piece of Ventrac equipment you own. Reading the *Operator's Manual* will help you become familiar with each specific piece of equipment. If this manual becomes damaged or unreadable, it should be replaced immediately. Contact your local Ventrac dealer for a replacement.

When using a Ventrac attachment, be sure to read and follow the safety and operating instructions of both the machine and the attachment being used to ensure the safest operation possible.

The information in this manual provides the operator with the safest procedures to operate the machine while getting the maximum use out of the unit. Failure to follow the safety precautions listed in this manual may result in personal injury and/or damage to the equipment.

Manual Conventions

This manual identifies potential hazards and has safety messages identified by the safety-alert symbol, which signals a hazard that may cause serious injury or death if you do not follow the recommended precautions.



This manual uses 2 words to highlight information. **Important** calls attention to special mechanical information and **Note** emphasizes general information worthy of special attention.

Safety Alert Classifications

The safety-alert symbol shown in this manual and on the machine identifies important safety messages that you must follow to prevent accidents.

Safety-alert symbol appears above information that alerts you to unsafe actions or situations and is followed by the word **DANGER**, **WARNING**, or **CAUTION**.



Danger indicates an imminently hazardous situation which, if not avoided, *will* result in death or serious injury.



Warning indicates a potentially hazardous situation which, if not avoided, *could* result in death or serious injury.



Caution indicates a potentially hazardous situation which, if not avoided, *may* result in minor or moderate injury.



Table of Contents

General Safety.....	2-2
Training Required	2-2
Operation Safety	2-2
Weedbine Safety.....	2-5
Maintenance Safety.....	2-5
Fuel Safety.....	2-7
Safety and Instructional Decals	2-8

General Safety

Training Required

- The owner of this machine is solely responsible for properly training the operators.
- The owner/operator is solely responsible for the operation of this machine and for the prevention of accidents or injuries occurring to him/herself, other people, or property.
- Do not allow operation or service by children or untrained personnel. Local regulations may restrict the age of the operator.
- Before operating this machine, read the *Operator's Manual* and understand its contents.
- If the operator of the machine cannot understand this manual, then it is the responsibility of this machine's owner to fully explain the material within this manual to the operator.
- Learn and understand the use of all the controls.
- Know how to stop the machine and the attachments quickly in the event of an emergency.

Operation Safety

- Secure long hair and loose clothing. Do not wear jewelry.
- Inspect the machine before operation. Repair or replace any damaged, worn, or missing parts. Be sure the guards and shields are in proper working condition and are secured in place. Make any necessary adjustments before operating the machine.
- Some pictures in this manual may show shields or covers opened or removed in order to clearly illustrate the instructions. Under no circumstance should the machine be operated without these devices in place.
- Alterations or modifications to this machine can reduce safety and could cause damage to the machine. Do not alter the safety devices or operate with the shields or covers removed.
- Before each use, verify that all the controls function properly and inspect all the safety devices. Do not operate if the controls or safety devices are not in proper working condition.
- Check the parking brake function before operating. Repair or adjust the parking brake if necessary.
- Observe and follow all of the safety decals.
- All the controls are to be operated from the operator's station only.
- Always wear a seat belt if the machine has a roll cage/bar installed and in the upright position.
- Ensure the attachment or accessory is locked or fastened securely to the machine before operating.
- Ensure that all bystanders are clear of the machine and the attachment before operating. Stop the machine if someone enters your work area.

Operation Safety (continued)

- Always be alert to what is happening around you, but do not lose focus on the task you are performing. Always look in the direction the machine is moving.
- Look behind and down before backing up to be sure of a clear path.
- If you hit an object, stop and inspect the machine. Make any necessary repairs before operating the machine again.
- Stop operation immediately at any sign of equipment failure. An unusual noise can be a warning of equipment failure or a sign that maintenance is required. Make any necessary repairs before operating the machine again.
- If equipped with a high/low range feature, never shift between high and low range while on a slope. Always move the machine to level ground and engage the parking brake before shifting range.
- Do not leave the machine unattended while it is running.
- Always park the machine on level ground.
- Always shut off the engine when connecting the attachment drive belt to the machine.
- Never leave the operator's station without lowering the attachment to the ground, engaging the parking brake, shutting off the engine, and removing the ignition key. Make sure all moving parts have come to a complete stop before dismounting.
- Never leave the machine unattended without lowering the attachment to the ground, engaging the parking brake, shutting off the engine, and removing the ignition key.
- Only operate in well-lit conditions.
- Do not operate when there is a risk of lightning.
- Never direct the discharge of any attachment in the direction of people, buildings, animals, vehicles, or other objects of value.
- Never discharge material against a wall or obstruction. The material may ricochet back toward the operator.
- Use extra caution when approaching blind corners, shrubs, trees, or other objects that may obscure your vision.
- Do not run the engine in a building without adequate ventilation.
- Do not touch the engine or the muffler while the engine is running or immediately after stopping the engine. These areas may be hot enough to cause a burn.
- Do not change the engine governor settings or over-speed the engine. Operating the engine at excessive speeds may increase the hazard of personal injury.
- To reduce the hazard of fire, keep the battery compartment, engine, and muffler areas free of grass, leaves, excessive grease, and other flammable materials.
- Clear the working area of objects that might be hit or thrown from the machine.
- Keep people and pets out of the working area.
- Know the work area well before operation. Do not operate where traction or stability is questionable.
- Reduce speed when you are operating over rough ground.

Operation Safety (continued)

- Equipment can cause serious injury and/or death when improperly used. Before operating, know and understand the operation and safety of the machine and the attachment being used.
- Do not operate the machine if you are not in good physical and mental health, if you will be distracted by personal devices, or if you are under the influence of any substance which might impair your decisions, dexterity, or judgment.
- Children are attracted to machine activity. Be aware of children and do not allow them in the work area. Turn off the machine if a child enters the work area.
- Machines, attachments, and accessories are not designed or intended for travel on public roadways. Never operate or travel on public roads or highways.
- Operate with safety lights when operating near roadways.
- Slow down and be careful of traffic when operating near or crossing roadways. Stop before crossing roads or sidewalks. Use care when approaching areas or objects that may obscure vision.
- Only allow the operator on the machine. Keep riders off.
- Never allow riders on any attachment or accessory.

Requirements for Personal Protective Equipment (PPE)

The owner is responsible for ensuring that all the operators use the proper PPE while operating the machine. Whenever you use the machine, use the following PPE:

- Certified eye protection and hearing protection.
- Closed toe, slip resistant footwear.
- Long pants or trousers.
- A dust mask for dusty conditions.
- Additional PPE may be required. Refer to the product safety procedures for any additional requirements.

Operating On Slopes

- Slopes can cause loss-of-control and tip-over accidents, which can result in severe injury or death. Be familiar with the emergency parking brake, along with the machine controls and their functions.
- If the machine is equipped with a fold down roll bar, it must be locked in the upright position when operating on any slope.
- Use low range (if equipped) when operating on slopes greater than 15 degrees.
- Do not stop or start suddenly when operating on slopes.
- Never shift between high and low range while on a slope. Always move the machine to level ground and engage the parking brake before shifting range or placing the machine in neutral.
- Variables such as wet surfaces and loose ground will reduce the degree of safety. Do not drive where the machine could lose traction or tip over.
- Keep alert for hidden hazards in the terrain.

Operation Safety (continued)

- Stay away from drop-offs, ditches, and embankments.
- Sharp turns should be avoided when operating on slopes.
- Pulling loads on hills decreases safety. It is the responsibility of the owner/operator to determine loads that can safely be controlled on slopes.
- Transport the machine with the attachment lowered or close to the ground to improve stability.
- Attachments and accessories may affect the stability of the traction unit. Refer to the attachment safety section of the attachment *Operator's Manual* for restrictions on the maximum angle of operation.
- While operating on slopes, drive in an up and down direction whenever possible. If turning is necessary while driving across slopes, reduce your speed and turn slowly in the downhill direction.
- Ensure a sufficient supply of fuel for continuous operation. A minimum of one-half tank of fuel is recommended.

Weedbine Safety

- Contact with the auger, brushes, or other moving parts may cause personal injury. Keep your hands and feet away.
- When removing a blockage, residual power in the system could cause injury through sudden movement of the brush or auger when the blockage is released. Never attempt to rotate the brush, auger, or clear a blockage using your hands or feet.
- Always shut off the PTO to stop the brush and auger whenever you are not actively using the Weedbine.

Maintenance Safety

- Keep the safety decals legible. Remove all grease, dirt, and debris from the safety decals and instructional labels.
- If any decals are faded, illegible, or missing, contact your dealer promptly for replacements.
- When new components are installed, be sure that the current safety decals are affixed to the replacement components.
- If any component requires replacement, use only original Ventrac replacement parts.
- Always turn the battery disconnect to the OFF position or disconnect the battery before performing any repairs. Disconnect the negative terminal first and the positive terminal last. Reconnect the positive terminal first and the negative terminal last.
- Keep all bolts, nuts, screws, and other fasteners properly tightened.
- Always lower the attachment to the ground, engage the parking brake, shut off the engine, and remove the ignition key. Make sure all moving parts have come to a complete stop before cleaning, inspecting, adjusting, or repairing.

Maintenance Safety (continued)

- If the machine, attachment, or accessory requires repairs or adjustments not instructed in the operator's manual, the machine, attachment, or accessory must be taken to an authorized Ventrac dealer for service.
- Never perform maintenance on the machine and/or attachment if someone is in the operator's station.
- Always use protective glasses when handling the battery.
- Check the fuel lines for tightness and wear on a regular basis. Tighten or repair them as needed.
- To reduce the hazard of fire, keep the battery compartment, engine, and muffler areas free of grass, leaves, and excess grease.
- Do not touch the engine, the muffler, or other exhaust components while the engine is running or immediately after stopping the engine. These areas may be hot enough to cause a burn.
- Allow the engine to cool before storing and do not store near an open flame.
- Do not change the engine governor settings or over-speed the engine. Operating engine at excessive speeds may increase the hazard of personal injury.
- Springs may contain stored energy. Use caution when disengaging or removing springs and/or spring-loaded components.
- An obstruction or blockage in a drive system or moving/rotating parts may cause a buildup of stored energy. When the obstruction or blockage is removed, the drive system or moving/rotating parts may move suddenly. Do not attempt to remove an obstruction or blockage with your hands. Keep your hands, feet, and clothing away from all power-driven parts.

Hydraulic Safety

- Make sure the hydraulic connections are tight and all hydraulic hoses and tubes are in good condition. Repair any leaks and replace any damaged or deteriorated hoses or tubes before starting the machine.
- Hydraulic leaks can occur under high pressure. Hydraulic leaks require special care and attention. Use a piece of cardboard and a magnifying glass to locate suspected hydraulic leaks.
- Keep your body and hands away from pinhole leaks or nozzles that eject high pressure hydraulic fluid. Hydraulic fluid escaping under high pressure can penetrate the skin causing serious injury, leading to severe complications and/or secondary infections if left untreated. If hydraulic fluid is injected into the skin, seek immediate medical attention no matter how minor the injury appears.
- Safely relieve all pressure in the hydraulic system before performing any work on the hydraulic system.
- Safely relieve all pressure on the auxiliary hydraulic system before disconnecting the auxiliary hydraulic quick couplers.
- Always disengage the weight transfer system (if equipped) before performing maintenance or repairs on the weight transfer system, the front hitch, or the lift hydraulics.

Fuel Safety

- To avoid personal injury or property damage, use extreme care in handling gasoline. Gasoline is extremely flammable, and the vapors are explosive.
- Do not refuel the machine while smoking or at a location near flames or sparks.
- Always refuel the machine outdoors.
- Do not store the machine or fuel container indoors where the fumes or fuel can reach an open flame, spark, or pilot light.
- Only store fuel in an approved container. Keep out of the reach of children.
- Never fill containers inside a vehicle or on a truck or trailer bed with a plastic liner. Always place the containers on the ground away from your vehicle before filling.
- Remove the machine from the truck or trailer and refuel it on the ground. If this is not possible, refuel the machine using a portable container, rather than from a fuel dispenser nozzle.
- Never remove the fuel cap or add fuel with the engine running. Allow the engine to cool before refueling.
- Never remove the fuel cap while on a slope. Only remove the fuel cap when parked on a level surface.
- Replace the fuel tank cap and the container cap securely.
- Do not overfill the fuel tank. Only fill to the bottom of the fuel neck, do not fill the fuel neck full. Overfilling of the fuel tank could result in engine flooding, fuel leakage from the tank, and/or damage to the emissions control system.
- If fuel is spilled, do not attempt to start the engine. Move the machine away from the fuel spill and avoid creating any source of ignition until the fuel vapors have dissipated.
- If the fuel tank must be drained, it should be drained outdoors into an approved container.
- Check the fuel lines for tightness and wear on a regular basis. Tighten or repair them as needed.
- The fuel system is equipped with a shut-off valve. Shut off the fuel when transporting the machine to and from the job, when parking the machine indoors, or when servicing the fuel system.

Safety and Instructional Decals

Safety decals and instructions are easily visible to the operator and are located near any area of potential danger. Replace any decal that is damaged or missing.



Keep all safety decals legible. Remove all grease, dirt, and debris from safety decals and instructional labels. If any decals are faded, illegible, or missing, contact your dealer promptly for replacements.

When new components are installed, be sure that current safety decals are affixed to the replacement components.

Decal Part: 00.0619

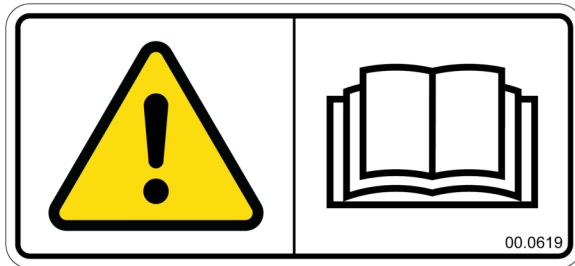

G546379

① Warning—Read
Operator's Manual.

Decal Part: 00.0631

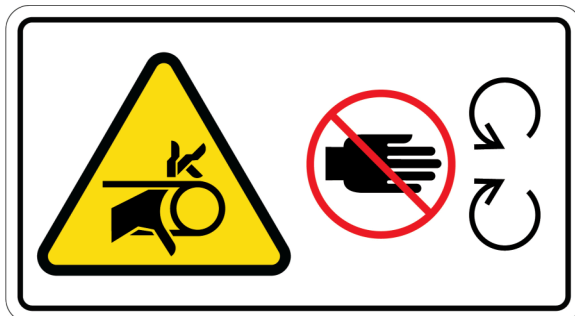

G546380

① Finger/Hand
Entanglement

Decal Part: 00.0625

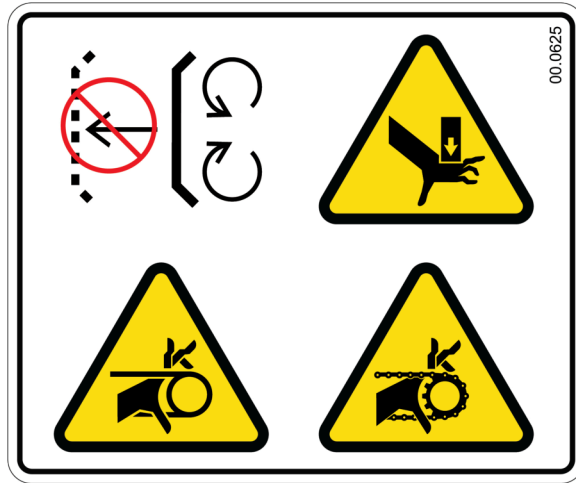

① Shield missing—Do not operate, pinching/crushing hazard, fingers or hand entanglement

Decal Part: 00.0364



① Pinch points—Moving parts can crush or cut

Decal Part: 00.0630



① Leg/Arm Entanglement



Table of Contents

Operational Controls	3-2
Height Adjustment Handles	3-2
PTO Drive Belt Tension Lever	3-2
Auger Drive Belt Tension Lever	3-3
Brush Drive Belt Tension Lever	3-3

Operational Controls

Note: Refer to the traction unit *Operator's Manual* for traction unit operational control locations.

Height Adjustment Handles

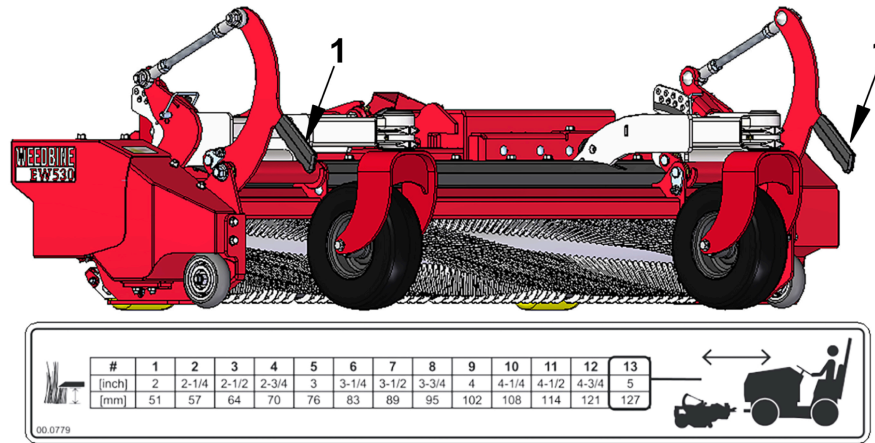

G541008

The height adjustment handles ^① are used to raise and lower the Weedbinder to the desired operating height. The right and left adjustment handles must be set to the same height position. The height position decal lists the adjustment handle positions and the corresponding cutting heights.

PTO Drive Belt Tension Lever

The PTO drive belt tension lever ^① is located under the PTO drive belt shield.

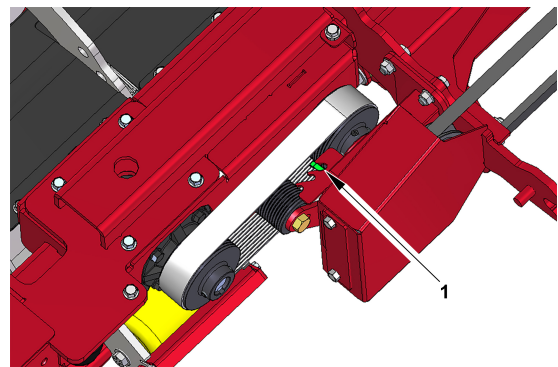

G541011

Auger Drive Belt Tension Lever

The auger drive belt tension lever^① is located under the upper auger drive belt shield.

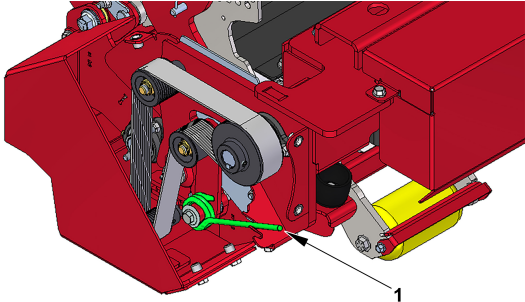

G541009

Brush Drive Belt Tension Lever

The brush drive belt tension lever^① is located under the upper brush drive belt cover.

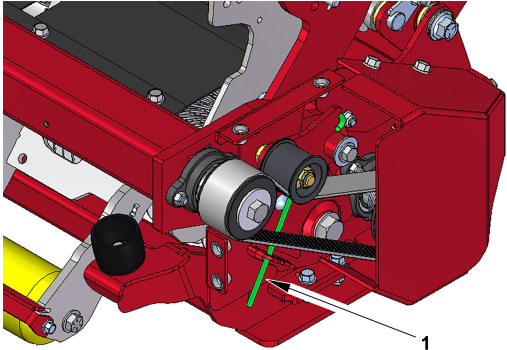

G541010



Table of Contents

Before Operation.....	4-2
Daily Inspection.....	4-2
Attaching the Attachment.....	4-3
Setting the Operational Height.....	4-4
During Operation.....	4-5
Operating the Machine	4-5
After Operation	4-6
Detaching the Attachment	4-6
Hauling the Machine.....	4-6

Before Operation

Daily Inspection



WARNING



Always engage the parking brake, shut off the traction unit engine, remove the ignition key, and ensure that all moving parts have come to a complete stop before inspecting the components, or attempting any repair or adjustment. Failure to do so can result in injury or death.

1. Park the machine on a level surface, engage the parking brake, and remove the key from the ignition.
2. Inspect the traction unit in accordance with the traction unit *Operator's Manual*.
3. Perform a visual inspection of the Weedbine. Replace any missing or damaged components before operating the machine.
4. Remove the drive belt covers and remove any debris.
5. Inspect the drive belts for damage. Replace any damaged belts before operating the machine.
6. Adjust the drive belt tension as needed.
7. Lubricate and grease the machine; refer to [Lubrication Locations, page 5–3](#).
8. Inspect the brush and auger. The brush bristle tips should be lightly touching the inner auger shaft, adjust the brush as needed; refer to [Adjusting the Brush, page 5–12](#).

Attaching the Attachment

Note: Refer to the traction unit *Operator's Manual* for operational control locations.

1. Drive the traction unit slowly forward into the hitch arms of the attachment. Align the lift arms of the traction unit with the attachment hitch arms by raising or lowering the front hitch and complete the engagement.
2. Once completely engaged, move the front hitch latch lever to the locked position. The latch ^① must lock over the attachment's hitch arm pin ^②.
3. Engage the parking brake and shut off the engine.
4. Place the attachment belt onto the PTO drive pulley on the traction unit. Ensure the belt is properly seated in each pulley.
5. Engage the PTO belt tensioner rod.

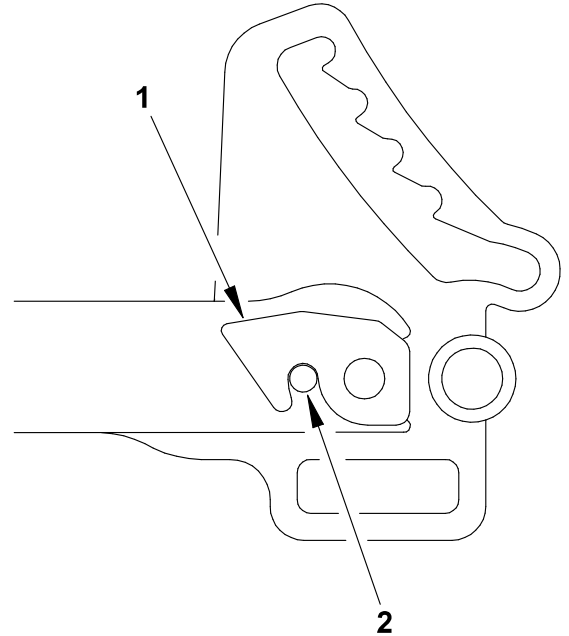

G541177

Setting the Operational Height

The operational height should match the cutting height at which the mower will be set. Refer to the decal located on top of the machine when setting the operational height.

The height adjustment handles must be adjusted evenly and set at the same setting during operation.

#	1	2	3	4	5	6	7	8	9	10	11	12	13
[inch]	2	2-1/4	2-1/2	2-3/4	3	3-1/4	3-1/2	3-3/4	4	4-1/4	4-1/2	4-3/4	5
[mm]	51	57	64	70	76	83	89	95	102	108	114	121	127

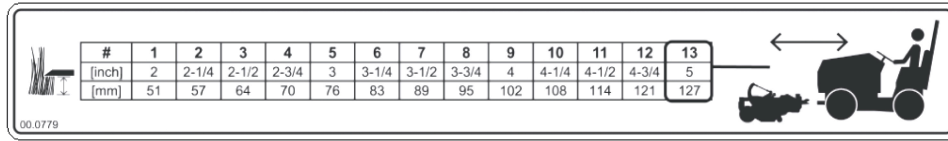

00.0779

G545023

1. Park the traction unit on a level surface, engage the parking brake, and remove the key from the ignition.
2. Hold the height adjustment handle (1) firmly.
3. Remove the pin (2).
4. Adjust the handle to the desired setting and install the pin.
5. Adjust the other side of the machine to the same setting.

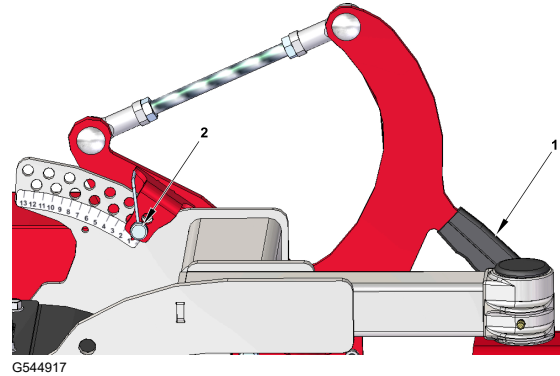

During Operation

Operating the Machine

1. Inspect the operating area, remove any rocks, sticks, or any other object that could damage or become entangled in the machine.
2. Set the traction unit weight transfer to 0 setting.
3. Lower the Weedbine to the ground in the float position.
4. Set the traction unit RPM between 2,000 and 3,000 RPM, engage the PTO switch, and adjust the throttle to 3600 RPM, full throttle.
5. Begin forward motion in the desired path. Ground speed should be 3.2 – 8 km/h (2 - 5 mph).
6. When operations are complete, slow the engine speed to between 2,000 and 3,000 RPM or lower before disengaging the PTO switch.

After Operation

Detaching the Attachment

Note: Refer to the traction unit *Operator's Manual* for operational control locations.

1. Park the traction unit on a level surface and engage the parking brake.
2. Lower the attachment to the ground.
3. Shut off the traction unit engine.
4. Disengage the PTO belt tensioner rod.
5. Remove the attachment belt from the PTO drive pulley of the traction unit.
6. Disengage the front hitch locking lever.
7. Start the traction unit and slowly back away from the attachment. A side to side movement of the steering wheel may aid in disengagement.

Hauling the Machine

- Use care when loading or unloading the machine into a truck or trailer.
- Use full width ramps for loading the machine into a truck or trailer.
- The parking brake is not sufficient to lock the machine during transport. Always secure the machine and/or attachment to the transporting vehicle securely using straps, chains, cables, or ropes. Both the front and rear straps should be directed down and outward from the machine.
- Shut off the fuel supply to the machine during transport on a truck or trailer.
- Turn the machine's battery disconnect switch to the OFF position to shut off electrical power.



Table of Contents

Recommended Maintenance Schedule	5-2
Lubrication Locations	5-3
Drive Belt Maintenance	5-4
Adjusting the PTO Drive Belt Tension	5-4
Adjusting the Auger Drive Belt Tension	5-5
Adjusting the Brush Drive Belt Tension.....	5-5
Replacing the Auger Drive Belt.....	5-6
Replacing the Brush Drive Belt.....	5-7
Replacing the PTO Drive Belt	5-7
Gearbox Maintenance	5-9
Checking the Gearbox Oil Level.....	5-9
Changing the Gearbox Oil	5-9
Auger Maintenance	5-10
Replacing the Auger	5-10
Brush Maintenance.....	5-12
Adjusting the Brush	5-12
Replacing the Brush	5-13
Storage	5-14
Preparing the Attachment for Storage	5-14
Removing the Attachment from Storage	5-14

Recommended Maintenance Schedule

Maintenance Service Interval	Maintenance Procedure
After the first 50 hours	Change the gearbox oil
Before each use or daily	Inspect the brush and auger.
	Inspect, for loose, missing, or worn components.
	Inspect the belts and pulleys.
	Inspect the safety decals.
Every 50 hours	Grease the Attachment
Every 500 hours	Change the gearbox oil
Yearly or before storage	Touch up chipped paint.

Lubrication Locations

Lubrication is required at the following locations using a lithium complex NLGI #2 grease.

Note: Clean the grease fittings before applying grease to the fittings.

Note: Refer to the [Recommended Maintenance Schedule, page 5-2](#) for service intervals.

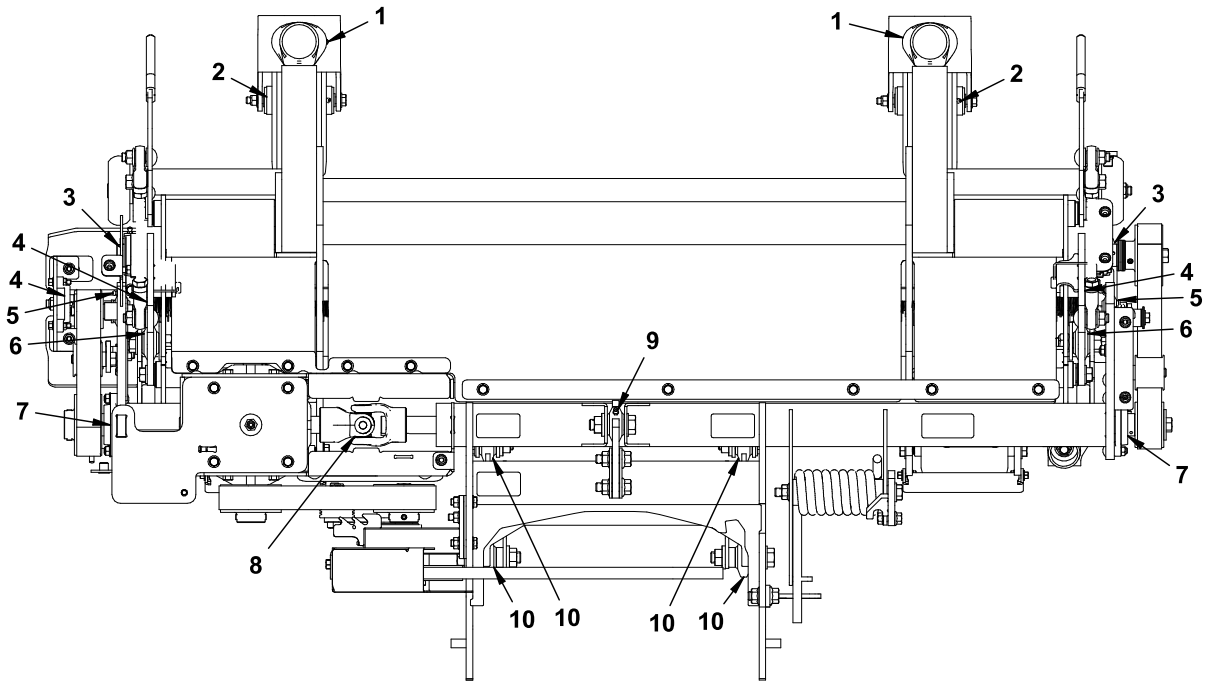

G544816

- | | |
|----------------------------|-----------------------|
| ① Wheel castor pivots | ⑦ Jack shaft bearings |
| ② Wheel axles | ⑧ Universal joint |
| ③ Brush shaft bearings | ⑨ Upper swivel link |
| ④ Auger shaft bearings | ⑩ Lower swivel links |
| ⑤ Cross frame pivots | |
| ⑥ Height adjustment pivots | |

Drive Belt Maintenance



WARNING



Always engage the parking brake, shut off the machine engine, remove the ignition key, and ensure that all moving parts have come to a complete stop before inspecting the components, or attempting any repair or adjustment.

Note: If any component requires replacement, use only original Ventrac replacement parts.

Inspecting the drive belts of the attachment can prevent sudden belt failure by finding problems before they cause a belt to break.

Typical wear on a belt may result in glazing, cracking, separation, streaked sidewall, rib loss, tensile break. If any of these conditions occur replace the belt.

Adjusting the PTO Drive Belt Tension

1. Remove the PTO drive belt shield.
2. Adjust the PTO drive belt tension lever .
3. Install the PTO drive belt shield.

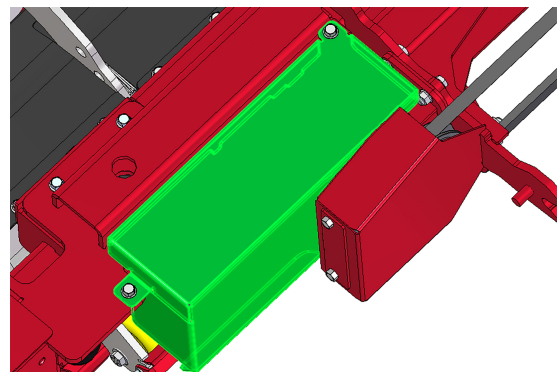

G541162

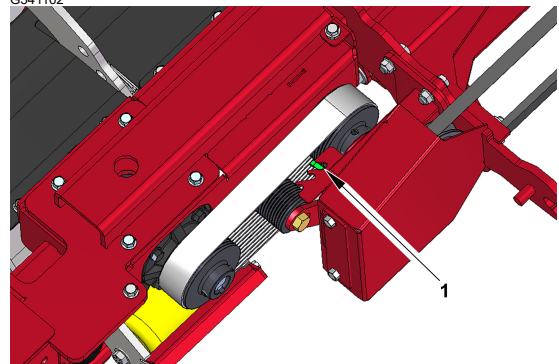

G541011

Adjusting the Auger Drive Belt Tension

1. Remove the auger drive belt shield.
2. Adjust the auger drive belt tension lever .
3. Install the auger drive belt shield.

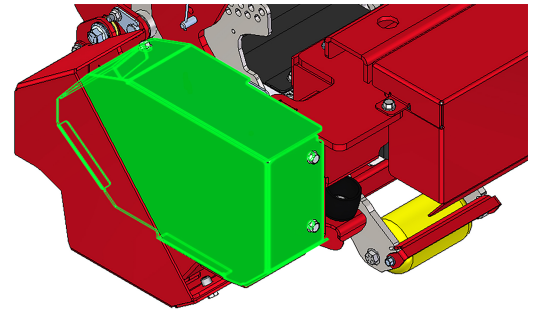

G541160

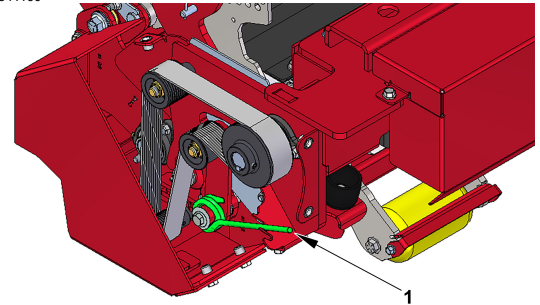

G541009

Adjusting the Brush Drive Belt Tension

1. Remove the brush drive belt shield.
2. Adjust the brush drive belt tension lever .
3. Install the brush drive belt shield.

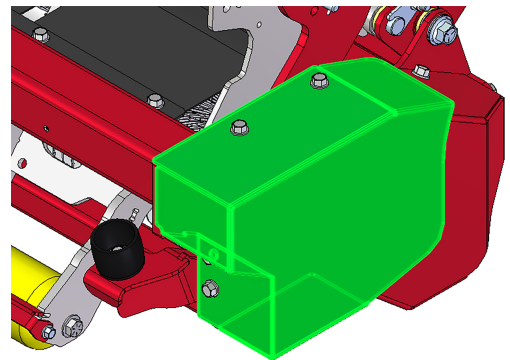

G541161

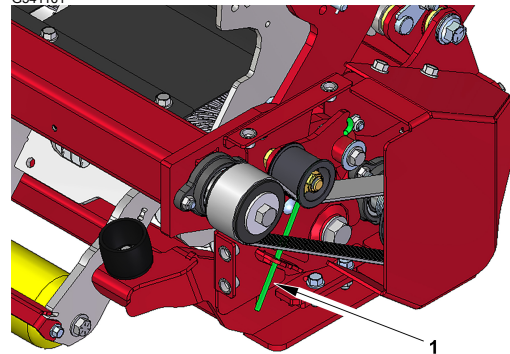

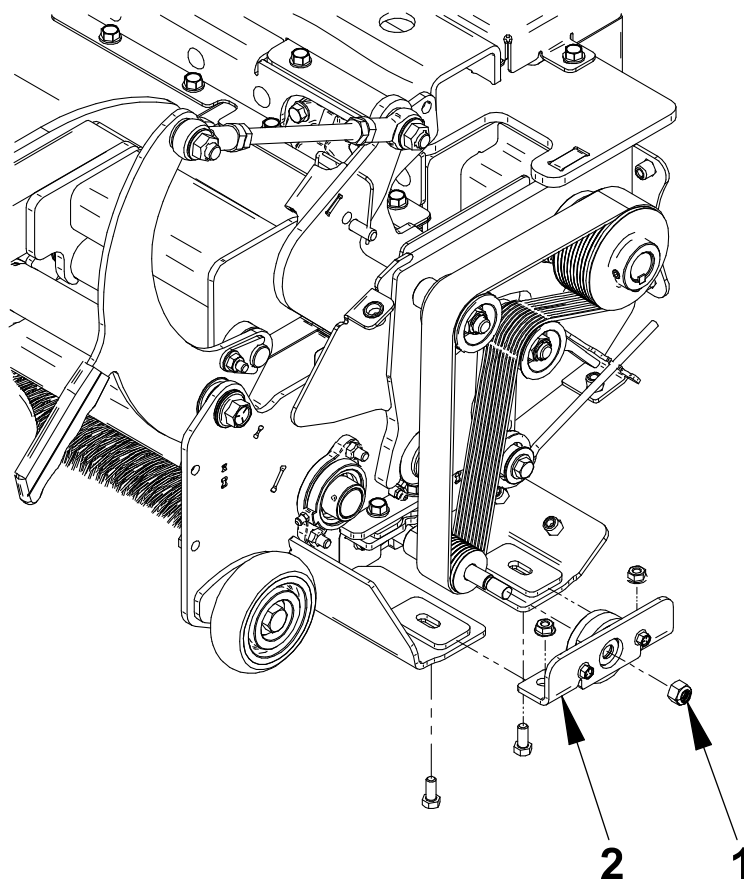

G541010

Replacing the Auger Drive Belt



G541192

1. Remove the attachment from the machine.
2. Remove the auger drive belt shields.
3. Adjust the auger drive belt tension, removing the tension from the belt.
4. Remove the flange bearing set screws.
5. Remove the axle nut^①.
6. Remove the auger bearing mounting plate^②.
7. Remove the belt from the pulleys.
8. To install the belt, route the belt over the pulleys.
-  9. Install the auger bearing mounting plate. Torque the mounting bolts to **24 N·m (210 in-lb)**.
10. Install the axle nut.
11. Install the bearing set screws.
12. Adjust the belt tension.
-  13. Install the auger drive belt shields. Torque the shield mounting bolts to **24 N·m (210 in-lb)**.

Replacing the Brush Drive Belt

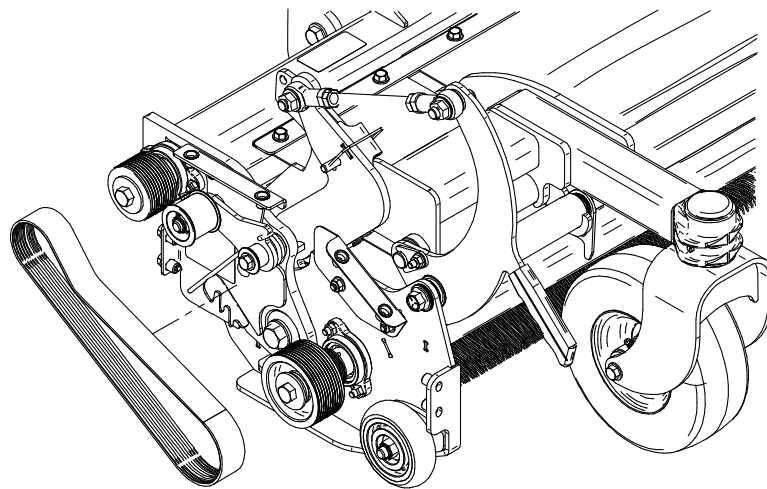

G541196

1. Remove the attachment from the machine.
2. Remove the brush drive belt shields.
3. Adjust the brush drive belt tension, removing the tension from the belt.
4. Remove the belt from the pulleys.
5. To install the belt, route the belt over the pulleys.
6. Adjust the belt tension.



7. Install the brush drive belt shields. Torque the shield mounting bolts to **24 N·m (210 in-lb)**.

Replacing the PTO Drive Belt

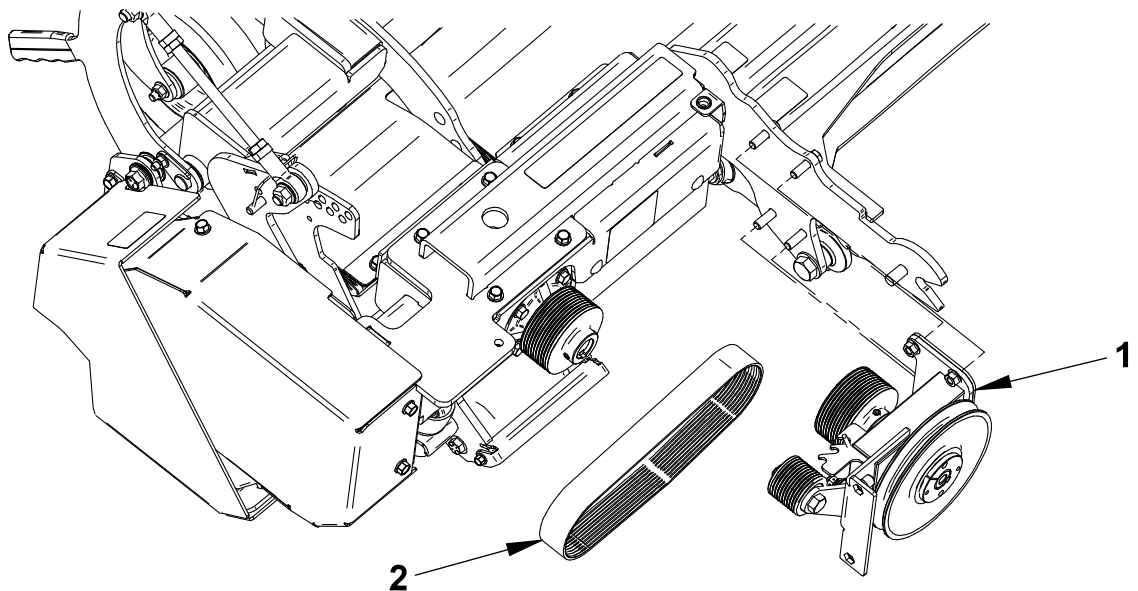

G541355

① Pulley mounting bracket

② Belt

Replacing the PTO Drive Belt (continued)

1. Remove the attachment from the machine.
2. Remove the PTO drive belt shield.
3. Remove the tension from the PTO drive belt.
4. Remove the PTO v-belt pulley mounting bracket^①.
5. Adjust the PTO drive belt tension, removing the tension from the belt.
6. Remove the belt^② from the pulleys.
7. To install the belt, route the belt over the pulleys.



8. Install the PTO v-belt pulley mounting bracket. Torque the mounting bolts to **42 N·m (31 ft-lb)**

9. Adjust the belt tension.



10. Install the PTO drive belt shields. Torque the shield mounting bolts to **24 N·m (210 in-lb)**.

Gearbox Maintenance

Checking the Gearbox Oil Level



1. Park the machine on a level surface, engage the parking brake, and remove the key from the ignition.
2. Clean the top of the gearbox and remove the relief valve^①.
3. The oil level should be maintained at approximately half full. If the oil level is low, add **75W-140** synthetic gear oil until the proper level is reached.
4. Install the relief valve.

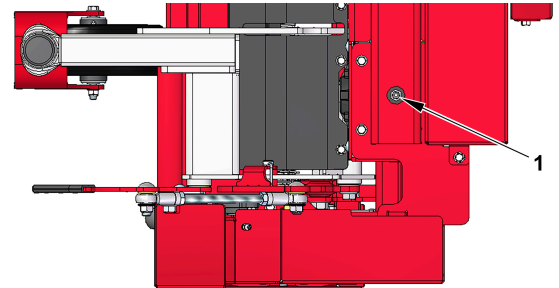

G543847

Changing the Gearbox Oil



1. Park the machine on a level surface, engage the parking brake, and remove the key from the ignition.
2. Clean the top and bottom of the gearbox.
3. Remove the relief valve from the top of the gearbox; refer to [Checking the Gearbox Oil Level, page 5–9](#).
4. Remove the drain plug^① located on the bottom of the gearbox and allow the oil to drain.
5. Install the drain plug.
6. Add **75W-140** synthetic gear oil until the oil level is approximately half full.
7. Install the relief valve.

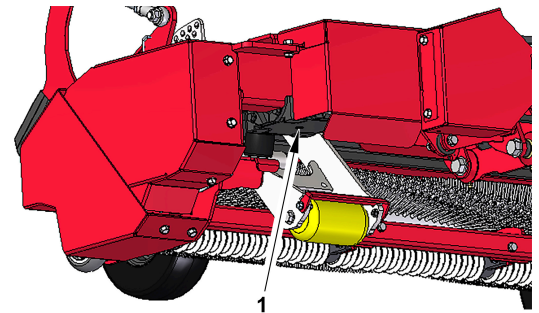

G543846

Auger Maintenance

Replacing the Auger

1. Remove the Weedbine from the traction unit.
2. Remove the upper and lower brush and auger drive belt covers.
3. Remove the auger drive belt; refer to [Replacing the Auger Drive Belt, page 5–6](#).
4. Remove the three bearing mount plates from the frame, by removing the 6 mounting bolts and washers^①.

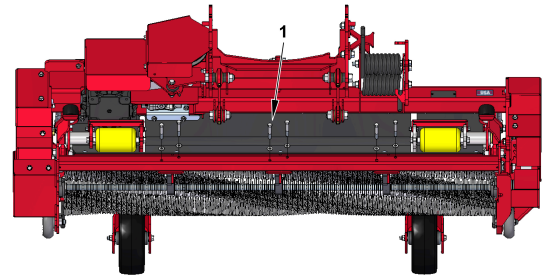

G542759

5. Remove the auger bearing slide mount mounting bolts^② from both sides of the frame.

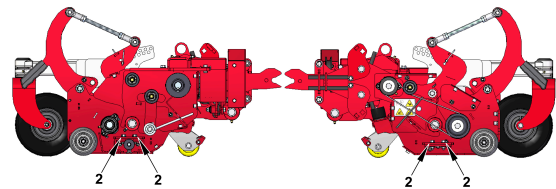

G542760

6. Remove the auger.
7. Remove the drive pulley from the auger shaft as needed.
8. Remove the flange bearings and bearing mounting plates from the auger shaft as needed.

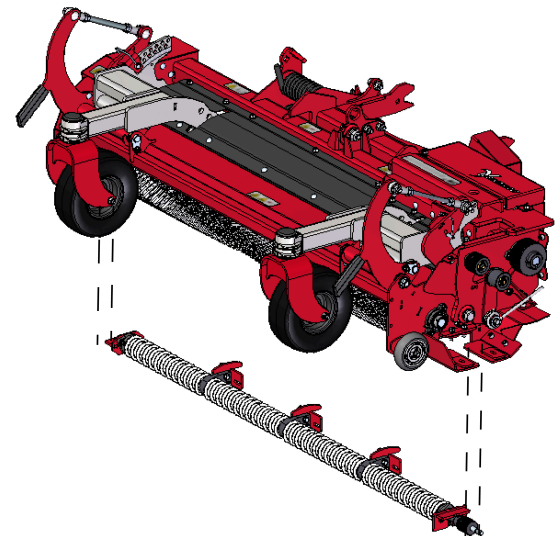

G542799



9. Install the bearing mounting plates on the new auger support bearings. Torque the mounting hardware to **24 N·m (210 in-lb)**.
10. Loosely install the flange bearings onto the shaft.
11. Position the auger shaft in the frame.



12. Install the flange bearings. Torque the mounting hardware to **24 N·m (210 in-lb)**.
13. Tighten the flange bearing set screws.



14. Install the three bearing mounting plates on the frame. Torque the mounting hardware to **24 N·m (210 in-lb)**.
15. Install the drive pulley on the axle.
16. Install the auger drive belt; refer to [Replacing the Auger Drive Belt, page 5–6](#).

Replacing the Auger (continued)



17. Install the upper and lower brush and auger drive belt covers. Torque the cover mounting hardware to **24 N·m (210 in-lb)**.

Brush Maintenance

Adjusting the Brush

1. Park the machine on a level surface, engage the parking brake, and remove the key from the ignition.
2. Remove the drive belt covers on both sides of the machine.
3. Loosen the brush flange bearing mounting bolts ^① on both sides of the machine.

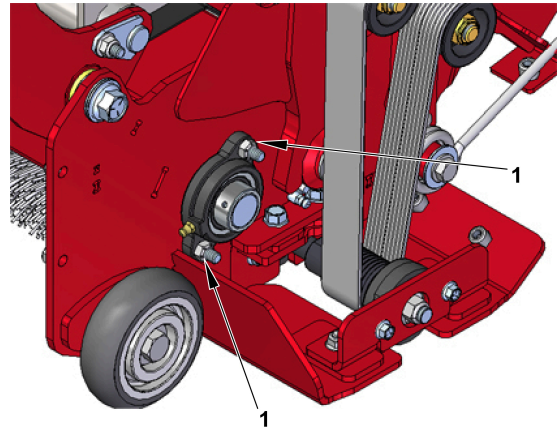

G544541

4. Adjust the brush so that the bristle tips are lightly touching the inner auger shaft ^②.
5. Tighten the brush flange bearing mounting bolts on both sides of the machine.

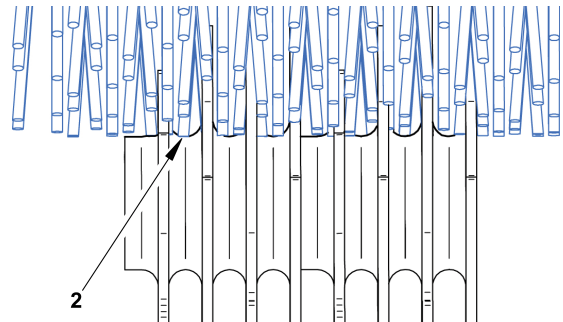

G544540

Storage

Preparing the Attachment for Storage

1. Clean the attachment.
2. Inspect the attachment for loose or missing hardware, damaged components, or signs of wear. Repair or replace any damaged or worn components.
3. Inspect the drive belts and replace if they are damaged or worn.
4. Inspect the brush and auger. Ensure the brush bristle tips are lightly touching the inner auger shaft and adjust the brush as needed.
5. Inspect the safety decals. Replace any decals that are faded, illegible, or missing.
6. Apply grease to all grease points and wipe off any excess grease.
7. Check the gearbox oil level.
8. Inspect the painted components for chips, scratches, or rust. Clean and touch up the surfaces as needed.

Removing the Attachment from Storage

1. Clean the attachment to remove any accumulated dust or debris.
2. Inspect the attachment as instructed in the Daily Inspection section of this manual.
3. Test the attachment to ensure that all the components are working properly.

Table of Contents

Auger will not rotate.

Possible Cause	Corrective Action
Debris are preventing the auger from rotating.	Remove any debris from the machine.
The auger drive belt is too loose.	Adjust the auger drive belt tension.
The auger drive belt is broken.	Replace the auger drive belt.

Brush will not rotate.

Possible Cause	Corrective Action
Debris are preventing the brush from rotating.	Remove any debris from the machine.
The brush drive belt is slipping.	Adjust the brush drive belt tension.
The brush drive belt is broken.	Replace the brush drive belt.



Table of Contents

Dimensions..... 7-2

Dimensions

Note: Specifications and design are subject to change without notice.

Width	164.16 cm (64.63 inches)
Length	88.9 cm (35 inches)
Height	53.97 cm (21.25 inches)
Weight	206.38 kg (455 lb)



Table of Contents

Limited Warranty — Ventrac Commercial Equipment..... 8-2

Limited Warranty — Ventrac Commercial Equipment

Venture Products, Inc., (henceforth referred to as V.P.I.) warrants on the terms and conditions herein, that it will repair, replace, or adjust any part manufactured by V.P.I., and found by V.P.I., to be defective in material and/or workmanship during the applicable warranty term.

All Ventrac commercial equipment purchased on or after January 1, 2019, will carry a 2-year commercial warranty. The warranty period begins on the date of original customer purchase:

Ventrac Commercial Equipment	Warranty Term
2000 Series SSV's and Attachments	2-year
3000 Series Tractors and Attachments	2-year
4000 Series Tractors and Attachments	2-year

All Ventrac add-on kits and accessories such as: 3-point hitch, 12V front & rear power outlets, foot pedal, dual wheel kit, etc., will be covered under the above warranty periods provided they are installed by an Authorized Ventrac Dealer. This warranty may be transferred and will carry the remainder of the warranty starting from the original purchase/registration date with the dealership and/or V.P.I.

The engine warranty is covered by its respective engine manufacturer. Please refer to the engine manufacturer's warranty statement that is included in the owner's manual.

For warranty consideration, the Ventrac commercial equipment, including any defective part, must be returned to an Authorized Ventrac Dealer within the warranty period. The warranty shall extend to the cost to repair or replace (as determined by V.P.I.) the defective part. The expense of pickup and delivery of equipment, service call drive time or any transportation expense incurred for warranty repair is the sole responsibility of the owner and is not covered under warranty by Ventrac and/or V.P.I. Ventrac and V.P.I.'s responsibility in respect to claims is limited to making the required repairs or replacements, and no claim of breach of warranty shall be cause for cancellation or rescission of the contract of sale of any Ventrac equipment. Proof of purchase may be required by the dealer to substantiate any warranty claim. Only warranty work performed and submitted by an Authorized Ventrac Dealer may be eligible for warranty credit.

This warranty extends only to Ventrac commercial equipment operated under normal conditions and properly serviced and maintained. The warranty expressly does NOT cover: (a) any defects, damage or deterioration due to normal use, wear and tear, or exposure; (b) normal maintenance services, such as cleaning, lubrication, oil change; (c) replacement of service items, such as oil, lubricants, spark plugs, belts, rubber hoses, bearings or other items subject to normal service replacement; (d) damage or defects arising out of, or relating to abuse, misuse, neglect, alteration, negligence or accident; (e) repair or replacement arising from operation of, or use of the equipment which is not in accordance with operating instructions as specified in the operator's manual or other operational instructions provided by V.P.I.; (f) repair or replacement arising as a result of any operation from Ventrac equipment that has been altered or modified so as to, in the determination of V.P.I., adversely affect the operation,

performance or durability of the equipment or that has altered, modified or affected the equipment so as to change the intended use of the product; (g) repair or replacement necessitated by the use of parts, accessories or supplies, including gasoline, oil or lubricants, incompatible with the equipment or other than as recommended in the operator's manual or other operational instructions provided by V.P.I.; (h) repairs or replacements resulting from parts or accessories which have adversely affected the operation, performance or durability of the equipment; or (i) damage or defects due to or arising out of repair of Ventrac equipment by person or persons other than an authorized Ventrac service dealer or the installation of parts other than genuine Ventrac parts or Ventrac recommended parts.

The sole liability of V.P.I. with respect to this warranty shall be the repair and replacement as set forth herein. V.P.I. shall have no liability for any other cost, loss, or damage. In particular V.P.I. shall have no liability or responsibility for: (i) expenses relating to gasoline, oil, lubricants; (ii) loss, cost or expense relating to transportation or delivery of turf equipment from the location of owner or location where used by owner to or from any Authorized Ventrac Dealer; (iii) travel time, overtime, after hours' time or other extraordinary repair charges or charge relating to repairs or replacements outside of normal business hours at the place of business of an Authorized Ventrac Dealer; (iv) rental of like or similar replacement equipment during the period of any warranty repair or replacement work; (v) any telephone or data charges; (vi) loss or damage to person or property other than that covered by the terms of this warranty; (vii) any claims for lost revenue, lost profit or additional cost or expense incurred as a result of a claim of breach of warranty; or (viii) attorney's fees.

The remedies of buyer set forth herein are exclusive and are in lieu of all other remedies. The liability of V.P.I., whether in contract, tort, under any warranty, or otherwise, shall not extend beyond its obligation as set forth herein. V.P.I. shall not be liable for cost of removal or installation nor shall V.P.I. be responsible for any direct, indirect, special or consequential damages of any nature. In no event shall V.P.I. be liable for any sum in excess of the price received for the goods for which liability is claimed.

All implied warranties, including merchantability and fitness for a particular purpose, are limited to the duration of the express warranty.

There are no representations or warranties which have been authorized to the buyer of the Ventrac commercial equipment other than set forth in this warranty. Any and all statements or representations made by any seller of this equipment, including those set forth in any sales literature or made orally by any sales representative, are superseded by the terms of this warranty. Any affirmation of fact or promise made by V.P.I. or any of its representatives to the buyer which relates to the goods that are the subject to this warranty shall not be regarded as part of the basis of the bargain and shall not be deemed to create any express warranty that such goods shall conform to the affirmation or promise.

No employee, distributor, or representative is authorized to change the foregoing warranties in any way or grant any other warranty on behalf of V.P.I.

Some states do not allow limitations on how long an implied warranty lasts or allow the exclusion on limitation of incidental or consequential damages, so the above limitation or exclusion may not apply to you.

This warranty gives you specific legal rights, and you may also have other rights which vary from state to state.

This warranty applies to all Ventrac commercial equipment sold by Venture Products Inc.